

Agenda Item 13.3 - Attachment 4

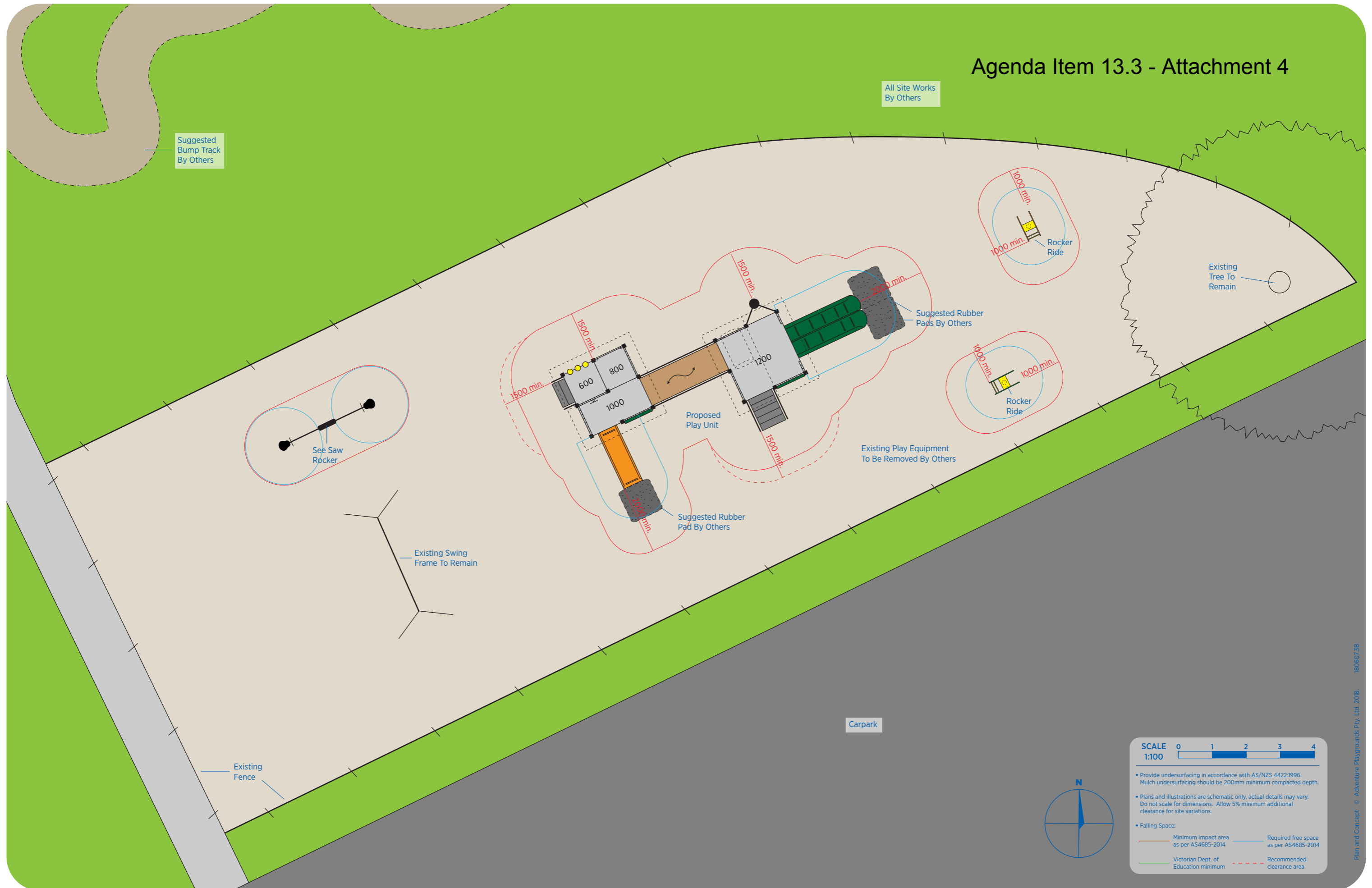

SCALE
1:100

0 1 2 3 4

- Provide undersurfacing in accordance with AS/NZS 4422:1996. Mulch undersurfacing should be 200mm minimum compacted depth.
- Plans and illustrations are schematic only, actual details may vary. Do not scale for dimensions. Allow 5% minimum additional clearance for site variations.
- Falling Space:

— Minimum impact area as per AS4685-2014	— Required free space as per AS4685-2014
— Victorian Dept. of Education minimum	- - - Recommended clearance area